



Indicative massing of proposals along Pershore Road

**Design & Access Statement**

---

# Design & Access Statement

## Contents

<b>1. INTRODUCTION</b>	4	4.3 Off-Site Manufacturing	17
1.1 Document Overview	4	4.4 Key Design Principles	18
1.2 Stirchley Co-Operative Trust - Vision and Objectives	5	4.5 Evolution	18
1.3 Stirchley Co-Operative Trust - History	5	4.6 Design and Appearance	18
1.4 Wider Economic, Environmental and Social Benefits	5	4.7 Form and Scale	19
1.5 Brief Introduction to the Scheme	6	4.8 Massing and Height	19
<b>2. SITE AND CONTEXT</b>	9	4.9 Environmental Assessment - Solar, Wind and Natural Light	19
2.1 Site Location	9	4.10 Sustainability	20
2.2 Existing Site Features	10	<b>5. THE DETAIL PROPOSAL</b>	20
2.3 Surrounding Context	11	5.1 Amount	20
2.4 Surrounding Buildings	12	5.2 Retail	22
<b>3. PLANINING CONTEXT</b>	14	5.3 Residential	22
3.1 Planning Policy	14	5.4 Building Materials and External Treatments	22
3.2 Statutory Services	15	5.5 Landscape	23
3.3 Topography	15	5.6 Drainage	23
3.4 Traffic Assessment	15	5.7 Secured by Design	26
3.5 Travel Plan	15	<b>6. ACCESS TO SITE</b>	27
3.6 Noise Survey	16	6.1 Local Facilities	27
3.7 Air Quality Assessment	16	6.2 Pedestrian, Cycling and Public Transport	28
<b>4. DESIGN STRATERGY</b>	17	6.3 Vehicular Access and Parking	30
4.1 Principles of Development	17	<b>7. CONCLUSION</b>	30
4.2 Tenancy	17		

# Design & Access Statement

---

## 1. INTRODUCTION

### 1.1 Document Overview

This Design and Access Statement has been prepared by Accord InDesign to support a full planning application for a new residential and retail mixed-use development.

The Applicant is Stirchley Co-operative Development, a property development co-operative company based in Stirchley, Birmingham.

This document is divided into the following sections: -

**Section 1** (Introduction) – this section provides an overview of this document and includes a brief description of the Stirchley Co-operative Development's aims; it also provides a brief introduction to the proposals.

**Section 2** (Site and Context) – this section places the scheme into context and analyses the site and application boundaries.

**Section 3** (Planning Context) – a brief review of planning policy and existing statutory services and site wide conditions impacting the site.

**Section 4** (Design Strategy) – the factors affecting and influencing the proposals are presented.

**Section 5** (The Detail Proposal) – this section furnishes an in-depth description of the scheme.

**Section 6** (Access to Site) – a site accessibility statement.

**Section 7** (Conclusion) – a summary of the proposals and conclusions deriving from the information supplied

## Design & Access Statement

### 1.2 Stirchley Co-Operative Trust – Vision and Objective

The aims of the Co-operative are to contribute to a regeneration of the locality and restore its former vibrancy for the good of the community. The members of the Co-operative have noted the steady decline of commercial enterprise and housing in Stirchley which has resulted in loss of facilities and opportunities to the community.

A key stated objective of the Co-operative is to give ‘people back control over their home and work environments’ and, in doing so, to draw on the rich history of Stirchley to forge a better future for the area.

### 1.3 Stirchley Co-Operative Trust – History

Stirchley Co-operative are a group of five housing and worker co-operatives based in Stirchley and the surrounding area. Formed approximately a decade ago, the society comprises Artefact, Birmingham Bike Foundry, Federici Housing Co-operative, Gung Ho Housing Co-operative, and Loaf Bakery and Cookery School.

For the past two years, Stirchley Co-operative Development has been working on proposals to make a singular contribution to the locality. In collaboration with Accord Housing Association, a registered social landlord with a track record of building affordable and sustainable houses, Stirchley Co-operative wish to develop a mixed-use retail and residential property on the Stirchley high street.

### 1.4 Wider Economic, Environmental and Social Benefits

The development will be a long-term asset contributing to the regeneration of the area. Run with high levels of community involvement and reduced negative environmental impacts, it aims to be sensitive to the past and ambitious about Stirchley’s future. Offering a sustainable alternative to private rental, this extensive project will help to tackle local social housing issues by providing dwelling and work space under common ownership.

The businesses involved have already served as catalysts for sustainable and locally led development in Stirchley, creating a business environment and customer base for new businesses to establish on the high street while respecting the history and heritage of Stirchley.

Historically, Stirchley has had a long history of co-operative organisations run for the community by the community, from TASCOS to the present day. This development builds on the noted recent momentum for co-operatives in the region to establish a “centre of excellence”, assisting new and established organisations to adopt a sustainable co-operative model.

Through working with Accord, the group has been keen to stress the importance of an environmentally conscious build in keeping with our values. With the exception of disabled parking, the building will be car-free, encouraging cycling, use of public transport and local car-sharing clubs. Ancillary plans include community composting, a kitchen garden and bee-hives.

As co-operative members, residents will be involved in the running of the building, developing transferrable skills in building management and community development.

Other benefits will include construction jobs and business linkages to the local economy arising out of demands for goods and services generated by the retail and residential occupancies.

## Design & Access Statement

### 1.5 Brief Introduction to the Scheme

The brief was to develop the disused parcel of land located at Plots 1382-1396, Pershore Road, to provide a mixed-use development of affordable residential accommodation and commercial retail units.

The requirement for residential units was drawn from a perceived affordable housing need in the area whilst the retail element is drawn from the need of the Co-operative's members for new premises.

Three businesses will take up residence in the new scheme. These are Artefact, Birmingham Bike Foundry and Loaf. These businesses are presently located in retail premises on Pershore Road which are not ideal for their development and growth.

#### ARTEFACT

Artefact is an artist-led gallery and community space established in 2015. It is run as a workers' co-operative with the ethos that an art space should benefit the community it is situated in. It is Artefact's mission to encourage creativity, educate through artistic practice and to ensure accessible and engaging experiences, using art to develop and enhance our understanding of the world around us.

Combining development opportunities for artists with community social events and educational activities, Artefact creates a vibrant, safe, space for Stirchley's broad demographic of people. Artefact's audiences are intergenerational and are from all backgrounds.

Artefact serves as a conduit to Birmingham's broad cultural offerings. Stirchley is a deprived area within Birmingham with reduced or at-capacity transport links to other areas of the city. Artefact forms partnerships with galleries, festivals and other cultural organisations in Birmingham ensuring the local community has access to a breadth of artistic experiences.



Fig 1 - Existing Artefact Shop on Peshore Road



## Design & Access Statement

Artefact's activities empower the local community, reduces the burden of poverty and encourages residents to engage with their locality in positive ways. A larger, purpose-built premises will enable Artefact to grow their audiences and deliver more professional and effective approaches in applying art to community solutions.

### BIRMINGHAM BIKE FOUNDRY

Birmingham Bike Foundry (BBF) is a worker co-operative specialising in bicycle repairs, refurbishment and training. Established in 2010, it has a number of goals alongside running a democratic workplace selling used bikes and cycle accessories.

BBF advocates increasing cycling for transport in Birmingham, acting as a hub for the local cycling community, promoting national campaigns and local events.

BBF refurbishes used bikes and makes them available at affordable prices. Many people get their first bike from BBF.

BBF offers schools work experience and maintenance classes, including autism specialist schools.

The repair shop is made available to the community through a Tool Club where cyclists can access equipment to repair their own bikes on the premises. This runs alongside more formal training in bike maintenance.

Above all, BBF strives to be open and friendly, believing cycling is for everyone and not an elite pursuit.



Fig 2 - Existing Birmingham Bike Foundry Shop on Pershore Road

## Design & Access Statement

### LOAF

Loaf Social Enterprise is a bakery and cookery school established in 2009 whose aims are to promote real food and healthy living in the community.

Loaf produces bread in line with the Real Bread Campaign and works to promote the concept of real bread to consumers and within the baking industry. Loaf runs bakery courses teaching basic and advanced skills to individuals, encouraging an awareness of what bread can and should be.

Loaf works with University College Birmingham's bakery department offering their students the rare chance to make real bread in a commercial bakery. They have also supported other real bread bakeries to increase the market for real bread in the UK. Locally, they work with schools and other organisations where appropriate.

The Loaf Cookery School has taught cookery skills to over 5,000 people from basic bread to seafood and butchery. The emphasis is on meals that can be made easily, bringing back forgotten skills and giving people control over their food. Loaf empowers people to make good food for themselves in their own homes and to question its origins.

In 2012 Loaf made a commitment to locate on the declining Stirchley high street rather than a more established market and has been a major influence on the development of the high street over the last decade. They have achieved this through their emphasis on sustainable slow growth and investment in local people through the co-operative model. Businesses such as CanEat, Isherwoods and Eat Vietnam had connections with Loaf before establishing in Stirchley and many other businesses have cited Loaf as a reason for moving to the area.

Loaf have reached the capacity limits of their current premises. Moving to larger premises with a secure future would enable Loaf to develop this work further, training and employing more bakers and expanding their reach in the locality and beyond.



Fig 3 - Existing Loaf Bakery Shop on Pershore Road



## Design & Access Statement

## 2. SITE AND CONTEXT

### 2.1 Site Location

The site lies east of Pershore Road in the Stirchley area of the City of Birmingham. It is located at the corner of Pershore and Hunts roads, approximately 7km south of the city centre. The land measures 2,292sqm, or 0.2ha.

Vehicular access is by means of either Pershore or Hunts roads, and existing access gates are present on both streets.

The immediate context of the land is primarily residential and retail. Pershore Road is effectively a high street of retail and commercial enterprise, whilst Hunts Road contains dwellings of likely Victorian origins. For the past few decades, this area of the city has suffered decline in commercial enterprise. Alongside this, the residential form is in need of regeneration. Today, large tracts of land remain undeveloped



Fig 4 - Site Location Map

## Design & Access Statement

### 2.2 Existing Site Features

- **Current Site Use**

The site is currently partly vacant and partly occupied by four disused buildings. The last known usage of the main buildings were as a kitchen manufacturer's enterprise.

The applicant has commissioned a number of surveys to determine the condition of the buildings prior to demolition and re-development.

Included in the surveys are land contamination and asbestos surveys. These reports now form an integral part of this submission.

- **Landscape**

The land is currently substantially a bare ground with very meagre vegetation and virtually no trees extant.

Opportunities for biodiversity enhancement will be explored in a soft landscaping scheme to be prepared by others.



Fig 5 - Existing site features on Pershore Road



## Design & Access Statement

### 2.3 Surrounding Context

- **Retail/ Mixed Use**

Maroon coloured areas indicate the existing retail and mixed use development which mainly fronts the A441 Pershore Road. The British Oak public house, a grade II listed building located to the north of the site is shown within this zone.

- **Residential**

Blue areas highlight the existing residential element in the locality.

- **New Residential - Planning**

Purple shaded zones denote new residential areas proposed for development by SevenCapital currently under planning consideration.

- **Commercial**

Green coloured areas indicate commercial buildings.



Fig 6 - Site Context Map

## Design & Access Statement

### 2.4 Surrounding Buildings

- **British Oak**

The British Oak Public House is a Grade II listed building, located to the north of the site. The proposals respect this asset of national heritage.

- **Commercial & Retail Units**

Commercial and retail developments occur to the south and west, including an estate agency located immediately adjacent from the land at the corner of Hunts and Pershore roads. Loaf presently occupy premises along Pershore Road just off the junction of Pershore and Mary Vale roads. Other retail units include the Co-operative Supermarket and Farmfoods.

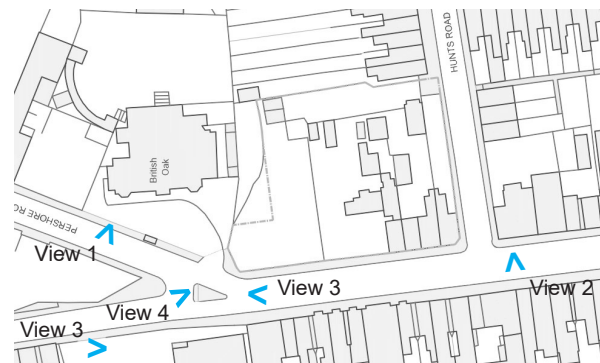

Fig 7 - View 1: existing listed British Oak Public House



Fig 8 - View 2: typical adjoining building on Pershore Road



Fig 9 - View 3: existing retail unit building at the junction



## Design & Access Statement

- Residential Dwellings**

Two storey traditionally built residential dwellings are to the site's eastern perimeter. To the north of the land, adjacent to the British Oak public house is vacant land that is proposed for further residential use to be developed by SevenCapital.



Fig 10 - View 4: existing key gateway view from the site and Pershore Road



Fig 11 - View 5: existing key gateway view from the Pershore Road junction to site



## Design & Access Statement

### 3. PLANINNG CONTEXT

#### 3.1 Planning Policy

Reference is made to Birmingham City's adopted development plan for the period up to 2031, adopted in January 2017.

Policy TP27, 'Sustainable Neighbourhoods', requires new residential developments to contribute to the creation of sustainable neighbourhoods. The definition of sustainability in this instance includes accessibility to amenities such as shops, schools, leisure, etc. and providing a range of house types, sizes and tenures. Other criteria include environmental sustainability through use of renewable technologies, creating of secure neighbourhoods and promoting of sustainable modes of travel.

Policy TP29, 'The Housing Trajectory', identifies a need for housing in Birmingham of which only up to 51,100 homes are planned for delivery by 2031. This figure is seen as inadequate to meet current housing need growth trajectories.

Policy TP30, 'The Type, Size and Density of New Dwellings', advises acceptable minimum densities for new developments. These include a requirement for up to 100 dwellings per hector for city centre locations.

Policy TP31, 'Affordable Housing', stipulates a minimum 35% contribution of affordable housing on major residential developments. This policy reflects the City's demand for this accommodation type.

These proposals positively address all of the above policies. The National Planning Policy Framework, January 2019, states,

'Small and medium sized sites can make an important contribution to meeting the housing requirement of an area, and are often built-out relatively quickly', NPPF, Jan. 2019, p.19.

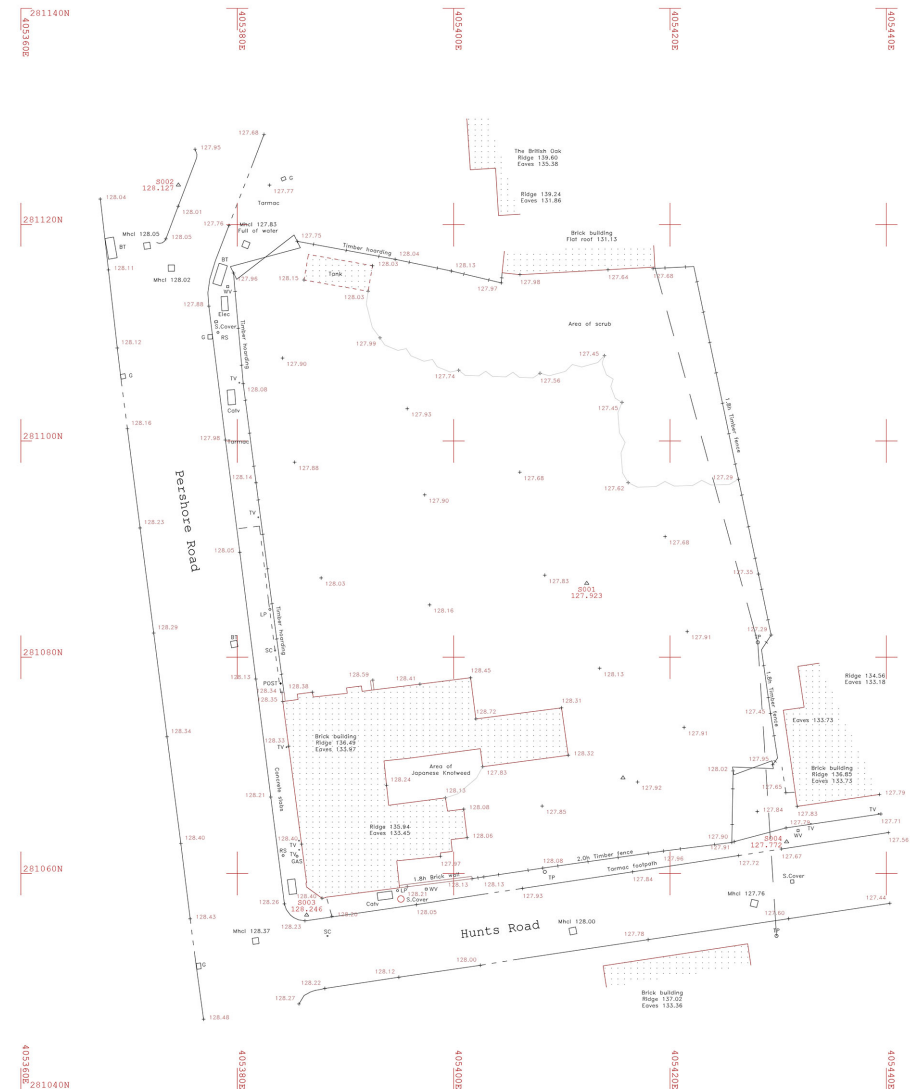

Fig 12 - Existing Topographical Survey Plan

## Design & Access Statement

### 3.2 Statutory Services

A full range of electricity, gas, water mains and data statutory service inquiries have been made. The results indicate that all services run beneath pedestrian footpaths within Highway land. Consequently, these services will not constrain the development.

### 3.3 Topography

An inspection of the topographical survey commissioned by the Applicant and prepared by Site Data (Sutton Coldfield) Ltd. shows [Figure 12] that the land is generally even with only gentle slopes.

Other features shown on the survey include the presence of dilapidated timber fences to the southern and eastern boundaries of the land. The new scheme proposes to remove these and replace them with new boundary treatments as indicated on the scheme proposals.

### 3.4 Traffic Assessment

PJA has been commissioned to demonstrate the lower level parking provision envisaged for the development, supporting the applicant's vision of sustainable development for the city. This is also in line with Birmingham City Council's policy of creating a carless society and cleaner air environment.

The site has been demonstrated to be in a highly sustainable location, being within walking distance of a variety of key amenities. The site is additionally in close proximity to key cycle routes, which provide access to key locations in the area such as Birmingham city centre.

The site is highly accessible by public transport and high frequency bus services stop in the vicinity of the site on Pershore Road. Bournville Railway Station lies within a 5 minutes walking distance.

Vehicular access to the site will be provided via a dropped-kerb access from Pershore Road. It is proposed to provide 52 cycle parking spaces on site, which is above the standards set out by Birmingham City Council.

It is proposed to provide three parking spaces with electric vehicle charging points. A thorough justification of the parking provision has been carried out, using census data, a review of car alternatives and by detailing the management strategy for the site. Please refer to PJA's Transport Statement for further details.

### 3.5 Travel Plan

PJA has been commissioned to prepare a Travel Plan to reduce the amount of single occupancy car travel to and from the site. The purpose of this study is to: -

- Reduce reliance on the car through the reduction in length and number of motorised journeys, in particular, those carried out in single occupancy vehicles;
- Promote the use of alternative means of travel which are more sustainable and environmentally friendly; and,
- Reduce emissions.

## Design & Access Statement

### 3.6 Noise Survey

A baseline noise survey was undertaken at the site between Friday 30th August and Monday 2nd September 2019 to assess prevailing noise levels at and in the vicinity of the site. Additional measurements were taken between 4th and 7th September 2019.

The general noise climate at the site was otherwise found to be controlled by road traffic noise, particularly along Pershore Road, plus human activities from pedestrians and patrons of The British Oak and other commercial properties nearby.

Figure 13 indicates the mitigation recommendations for the proposed development. Further detail can be found in the Enviromental Noise Survey Report.

### 3.7 Air Quality Assessment

A detailed air quality assessment, based on the potential impacts associated with a proposed development off Pershore Road, Stirchley, Birmingham, has been conducted using the atmospheric dispersion model, ADMS-Roads.

The assessment has also considered dust and fine particulate matter during the construction phase, and road traffic emissions during the operational phase. During the construction phase, the risk of dust soiling effects is classed as low for demolition and earthworks, medium for construction and low for trackout; the risk of human health effects is classed as negligible for demolition and earthworks, low for construction and negligible for trackout. Mitigation measures have been proposed to further reduce any potential impacts based on best practice guidance.

Further detail can be found in the Air Quality Assesment.



Fig 13 - Proposed Facade sound insulation area and glazing performance